

TI 1104 – Gas pipe inspection notice

MACHINES AFFECTED: Dryer models: TD30, TD50, TD75 (gas heated only).

On the above referenced models, it is possible for the gas-pipe support brackets on the right side of the burner compartment (viewed from the front) to rub against the gas pipe, causing a wear groove to develop in the pipe due to normal machine vibration.

Dealers and owners are instructed to conduct an immediate visual inspection at two points “A” (where the gas pipe is supported by the two brackets), and point “B” (where the gas pipe passes through the back panel of the dryer).

If grooves are found on the gas pipe, turn off the gas supply and the electrical service to the machine, placing it out of service, and contact Wascomat’s Technical Support department at 516-371-0700 for further instructions.

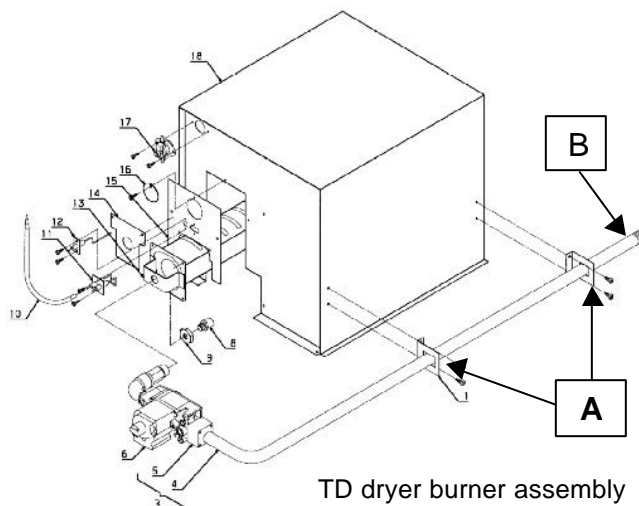

Note that some small scratches and / or wear marks on the gas pipe are normal.

A corrective action Technical Instruction bulletin will be sent to you, providing instructions to permanently correct this item.

Call Wascomat Technical Support at 516-371-0700 for additional assistance.

7/24/03